

## Clamping arm extenders for toggle clamps with solid clamping arm

### SPECIFICATION

Steel **ST**  
zinc plated, blue passivated

### INFORMATION

With clamping arm extenders GN 809.1, various toggle clamps with "solid clamping arm" can be easily and quickly extended. The slot of the extender corresponds to the dimensions of the respective toggle clamp size with "forked clamping arm" and is therefore compatible with all accessories, such as flanged washers, clamping screws, etc. For assembly, the clamping arm extenders are solid onto the clamping arms of the toggle clamps and bolted into place. The required holes in the clamping arm of the toggle clamp must be made by the user.

All parts are supplied in a non-assembled set. Two flanged washers are included for fastening the clamping screw.

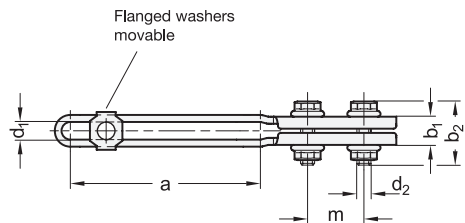
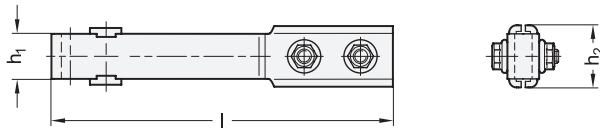

Application example

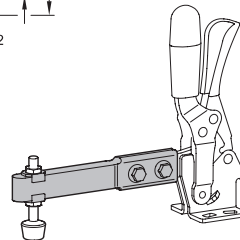

### GN 809.1

Description	a	h1	b1	b2	d1	d2	h2	m	l	w	for toggle clamps		
											GN 810	GN 820	Scale
GN 809.1-67.5-16-ST	67.5	16	10	21.5	6.3	M 5	21.5	20	121	3	130	130	99
GN 809.1-71.5-18-ST	71.5	18	12	26.5	8.2	M 6	24.5	26	142	4	230	230	165